



Candidate Barcode label

SC/NSC Answer Book

Senior Certificate/National Senior Certificate Grade 12 – May/June 2025 *Confidential*

CENTRE NUMBER							
---------------	--	--	--	--	--	--	--

[illegible]

<b>DATE</b>	
-------------	--

<b>BOOK NUMBER</b>		<b>OF</b>		<b>BOOKS</b>
--------------------	--	-----------	--	--------------

<b>SUBJECT CODE</b>					
---------------------	--	--	--	--	--

PAPER NUMBER	2
--------------	---

SUBJECT NAME	MATHEMATICAL LITERACY
--------------	-----------------------

[illegible]

**CONTROLLED AND CERTIFIED CORRECT**  
(SURNAME AND INITIALS OF EA)

READ INSTRUCTIONS ON THE NEXT PAGE.

**This answer book consists of 17 pages.**

**FOLLOW THESE INSTRUCTIONS CAREFULLY.**

1. Clearly write your examination number and centre number in the space provided and attach your barcode label in the space provided.
2. Remember that your own name (or the name of your school) may not appear anywhere on or in this answer book.
3. Answer ALL questions in the spaces provided.
4. No pages may be torn from this answer book.
5. Read the instructions printed on your timetable carefully as well as any other instructions which may be given in each examination paper.
6. Candidates may not retain an answer book or remove it from the examination room.
7. Answers must be written in black/blue ink as distinctly as possible.
8. Do not write in the margins.
9. If you require additional space for your answers:
  - 9.1 Use the additional space provided at the end of the answer book.
  - 9.2 When answering a question in the additional space, indicate clearly the question number in the column on the left-hand side.
10. Draw a neat line through any work that must not be marked.

**QUESTION 1**

	<b>Solution</b>	<b>Marks</b>
1.1.1		(2)
1.1.2		(2)
1.1.3		(2)
1.1.4		(2)
1.2.1		(2)
1.2.2		(2)
1.2.3		(2)
1.2.4		(2)
1.3.1		(2)
1.3.2		(2)
1.3.3		(2)
1.3.4		(3)
1.3.5		(3)
		<b>[28]</b>

QUESTION 2

2.1 ANNEXURE A

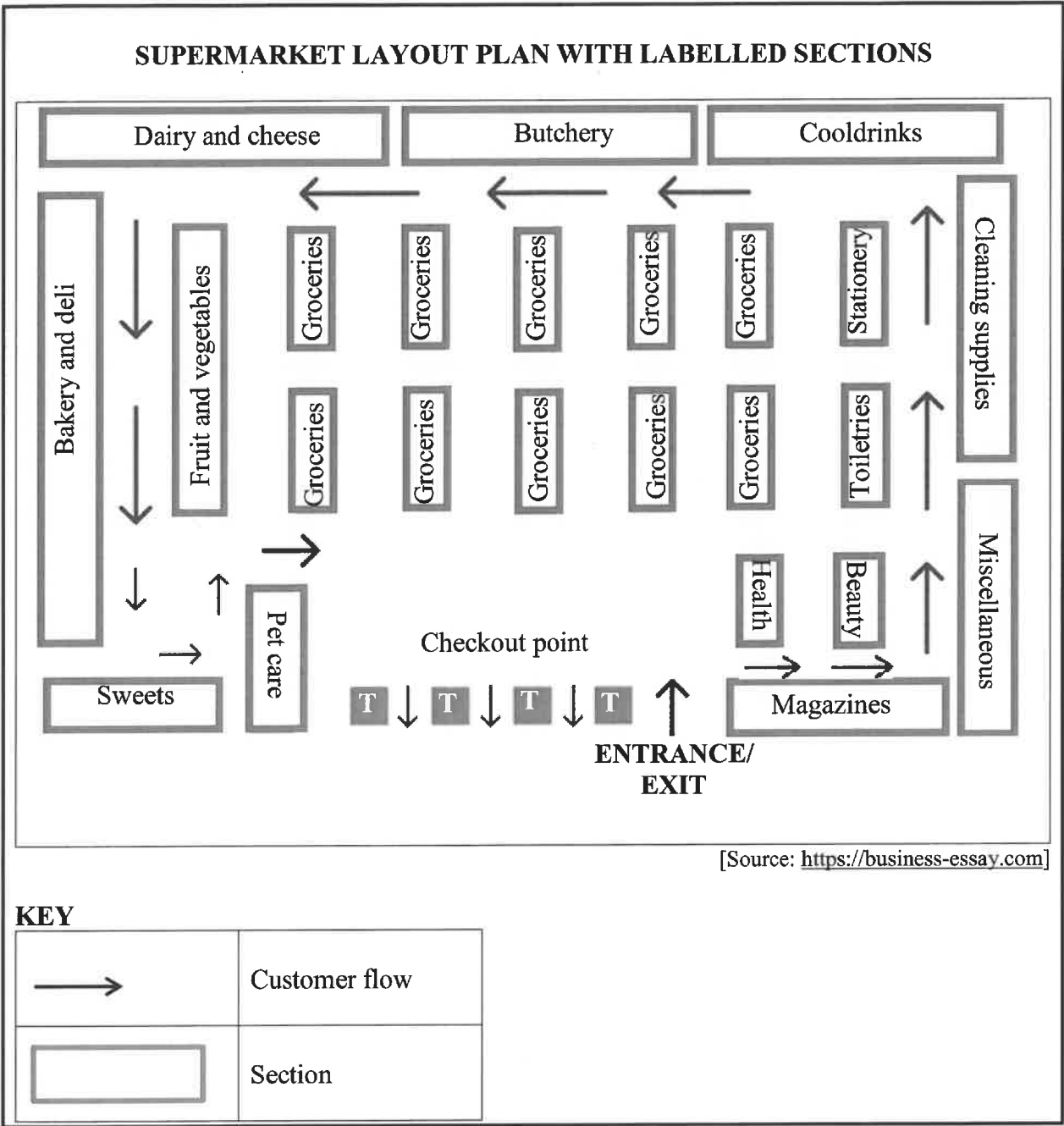

	<b>Solution</b>	<b>Marks</b>
2.1.1		(2)
2.1.2		(2)
2.1.3		(2)
2.1.4		(2)
2.1.5		(2)
2.1.6		(2)
2.1.7		(2)
2.2.1		(4)
2.2.2		(2)
2.2.3		(3)
		<b>[23]</b>

QUESTION 3

3.1 ANNEXURE B

PLAN OF MRS MBELE'S PROPOSED GARDEN, WITH MEASUREMENTS

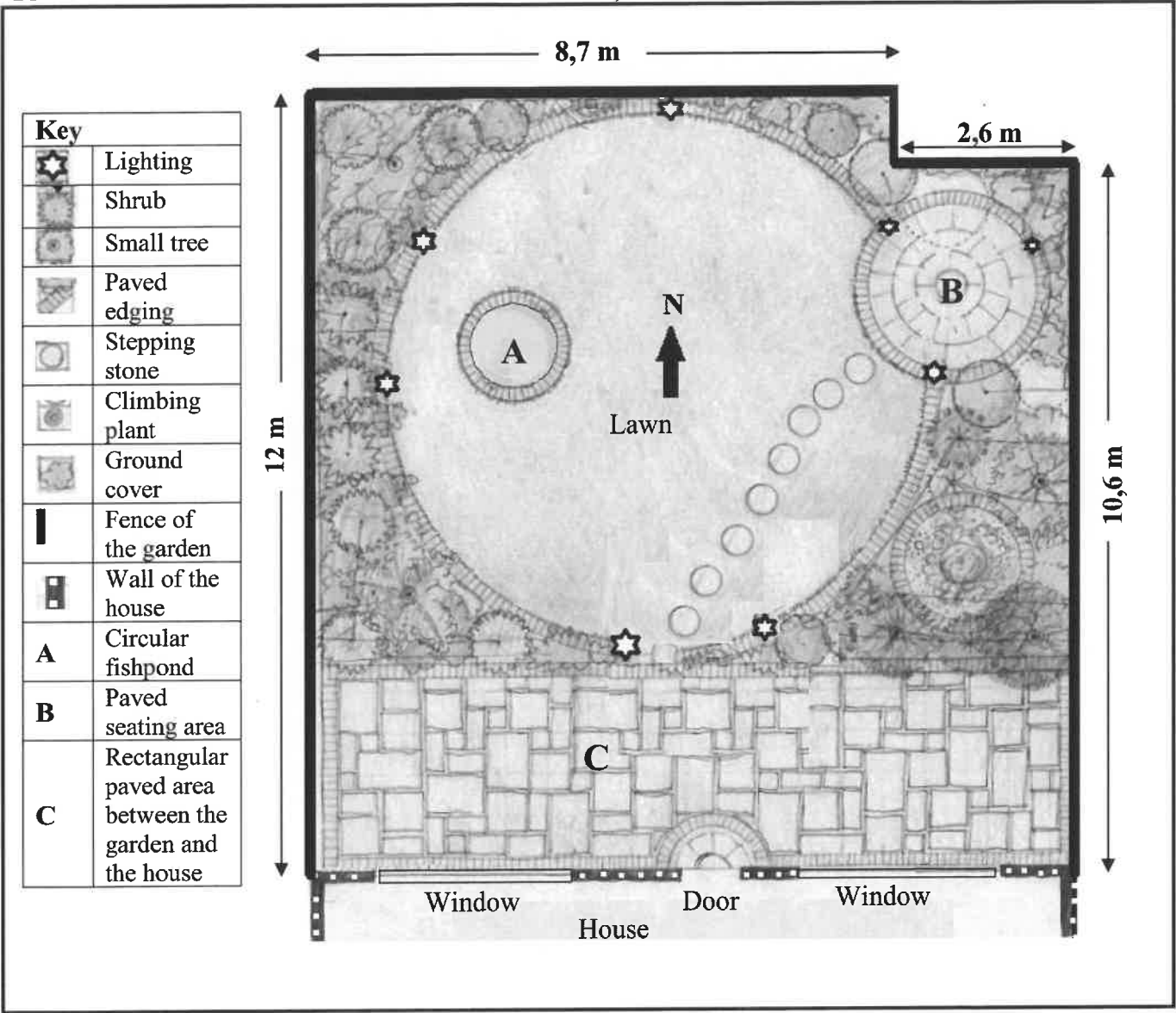

	<b>Solution</b>	<b>Marks</b>
3.1.1		(3)
3.1.2(a)		(4)
3.1.2(b)		(3)
3.1.3(a)		(4)
3.1.3(b)		(6)

	Solution	Marks
3.2.1		(2)
3.2.2		(5)



**QUESTION 4**

	<b>Solution</b>	<b>Marks</b>
4.1.1		(3)
4.1.2		(5)
4.1.3		(7)

	<b>Solution</b>	<b>Marks</b>
4.2.1		(1)
4.2.2		(1)
4.2.3		(1)
4.2.4		(1)
4.2.5		(1)
4.2.6		(1)
4.3.1		(4)

	Solution	Marks
4.3.2		(7)
4.3.3		(4)
		[36]

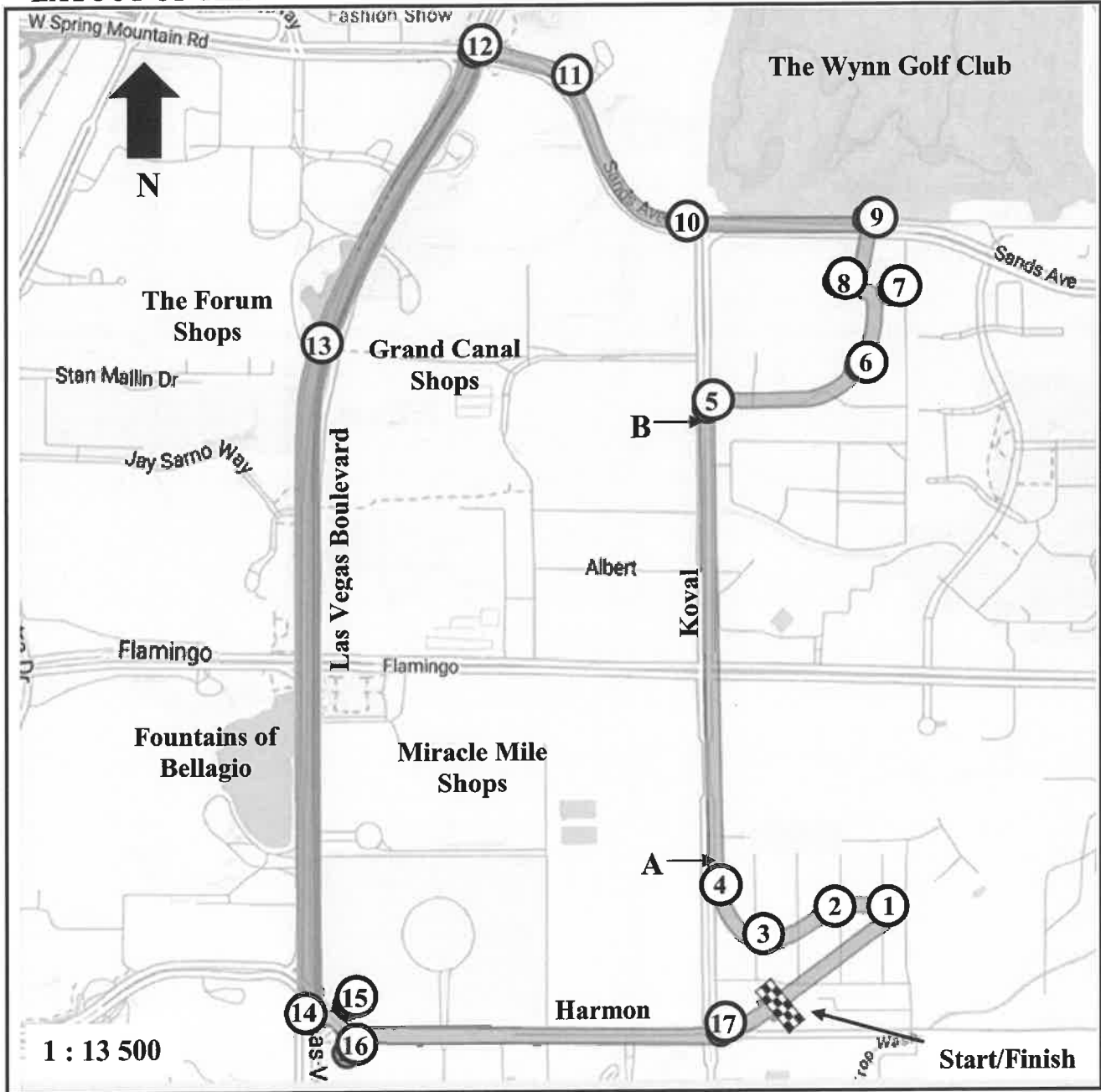
**QUESTION 5****5.1 ANNEXURE C****LAYOUT OF THE LAS VEGAS GRAND PRIX RACING TRACK**[Adapted from <https://oversteer48.com>]

	Solution	Marks
5.1.1		(2)
5.1.2		(2)
5.1.3		(2)
5.1.4		(2)
5.1.5		(7)
5.1.6		(3)

	Solution	Marks
5.2.1		(3)
5.2.2		(6)

	Solution	Marks
5.3.1		(6)
5.3.2		(3)
		[36]

Additional space		Marks



**TOTAL: 150**

<b>RE-MARK/RE-CHECK</b>				
<b>Question</b>	<b>Marks</b>			<b>Initials</b>
<b>1</b>				
<b>2</b>				
<b>3</b>				
<b>4</b>				
<b>5</b>				
<b>TOTAL</b>				
<b>HASH TOTAL</b>				